

4 Functions :

- 4/5mm hex key with 5Nm torque alert function
- T25 & flat head screwdriver

Specifications :

- Preset to 5Nm.
- No calibration or maintenance needed
- Rated to 10000 clicks
- IPX4 weather resistance

How to



Instructions of Use:

- Pull out the desired tool (5mm, 4mm or T25) until it is fully extended.
The body of the tool will limit how far each bit can be extended in order to ensure ultimate accuracy.
- Turn the chosen bolt until you feel the bolt tightening and offering resistance.
- According to Figure 1, place your thumb on Point A and your index finger on Point B.
- Your remaining fingers should not be in contact with the tool as this may affect accuracy.
- Continue to tighten the bolt until the button clicks, indicating 5Nm of torque has been reached.

Figure 1

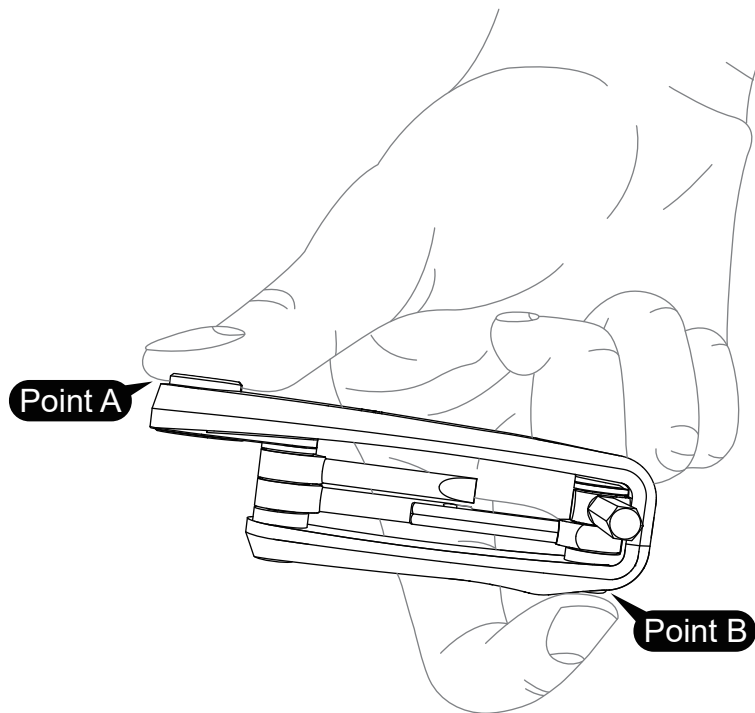

- T25 can be moved to the torque-enabled end of the tool, by swapping the T25 with the 4mm hex key.

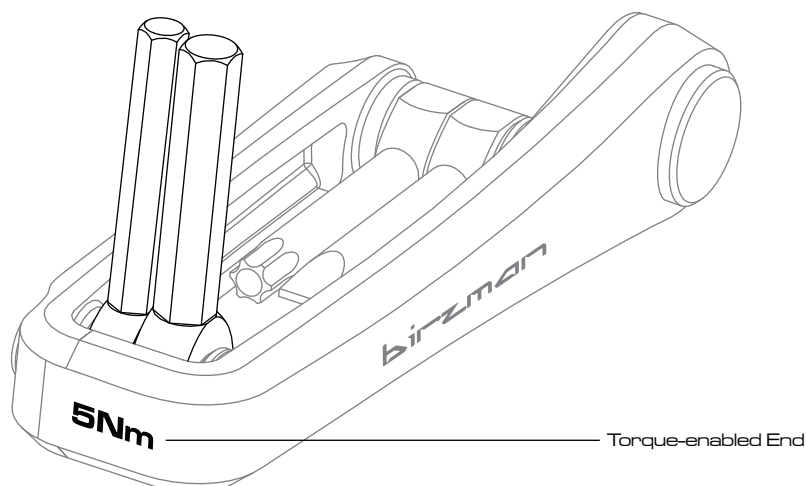

4/5mm hex key combination:

- When using the 4/5mm hex key combination on the torque-enabled end, please make sure the tool is assembled according to Figure 2.
- To maintain the accuracy of the tool, DO NOT dismantle or disassemble the torque button.

Figure 2

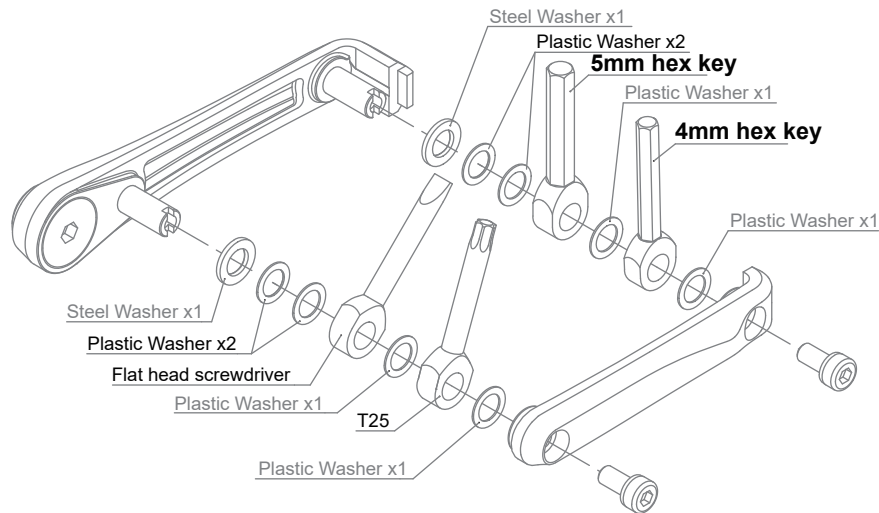

T25/5mm hex key combination:

- When using T25 /5mm hex key combination on the torque-enabled end, please make sure the tool is assembled according to Figure 3.
 - Move 1 pc plastic washer across to the other end when switching the 4mm hex key with the T25 from side A to side B.
- During assembly, please take care not to lose any small parts as any loss of washers and other parts will not be covered by warranty.

Figure 3

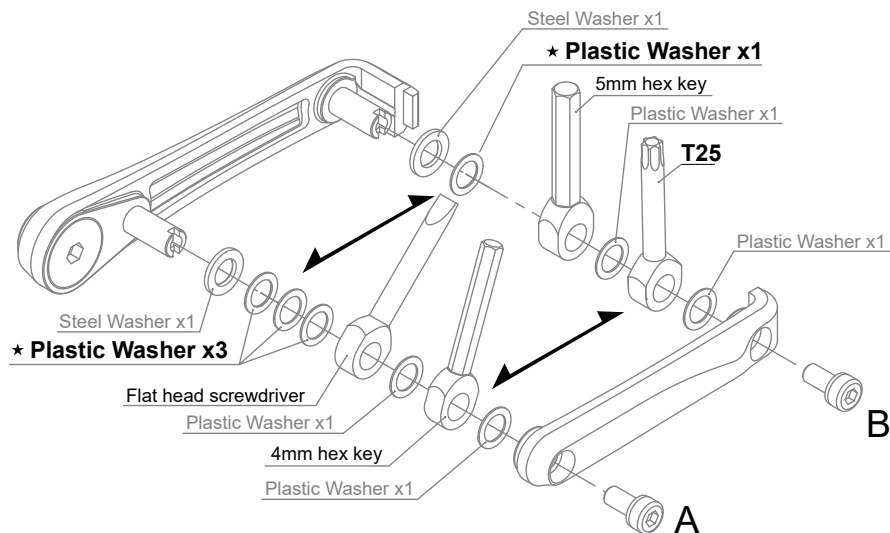

Note :

- The T25 must not be swapped with the 5mm hex key.
- The torque feature is for the purpose of precautionary measure only.
- The degree of accuracy may be subject to variances including personal use and/or parts serviced.
- For the proper maintenance of your tools, please apply a rust preventive oil regularly.
- All tools should be stored in a dry environment.